

Fence or Curb Cut Diagram

PLEASE ILLUSTRATE NEATLY AND COMPLETE IN ITS ENTIRETY

Project Address:

Project No.:

Date:

INFORMATION REQUIRED:

- Show location of your driveway and your neighbor's driveway, if any.
- Specify locations and dimensions of all existing building and structures on the lot.
- Specify location and dimension width of proposed curb cut, if any.
- Specify, **in red**, location and dimension length and height of fence, if any.

NOTES:

1. Gates, fences, doors, and similar objects cannot swing over the public property or right-of-way.
2. A completed "Common Property Line Wall/Fence Agreement" form signed by all of the common property owners shall be submitted prior to Planning's approval or permit issuance for fence walls proposed on the common property lines.
3. A lot survey by a registered land surveyor may be required to verify the proper location of the proposed fence. (LBMC 18.07.060)
4. The proposed work shall not destroy or unreasonably interfere with any access or utility easement belonging to others and located on this property. In the event such work may destroy or unreasonably interfere with such easement, a substitute easement(s) satisfactory to the holder(s) of the easement will be provided. (LBMC 18.04.050.D)
5. Historic landmarks or properties located in historic districts will require an approved Certificate of Appropriateness.

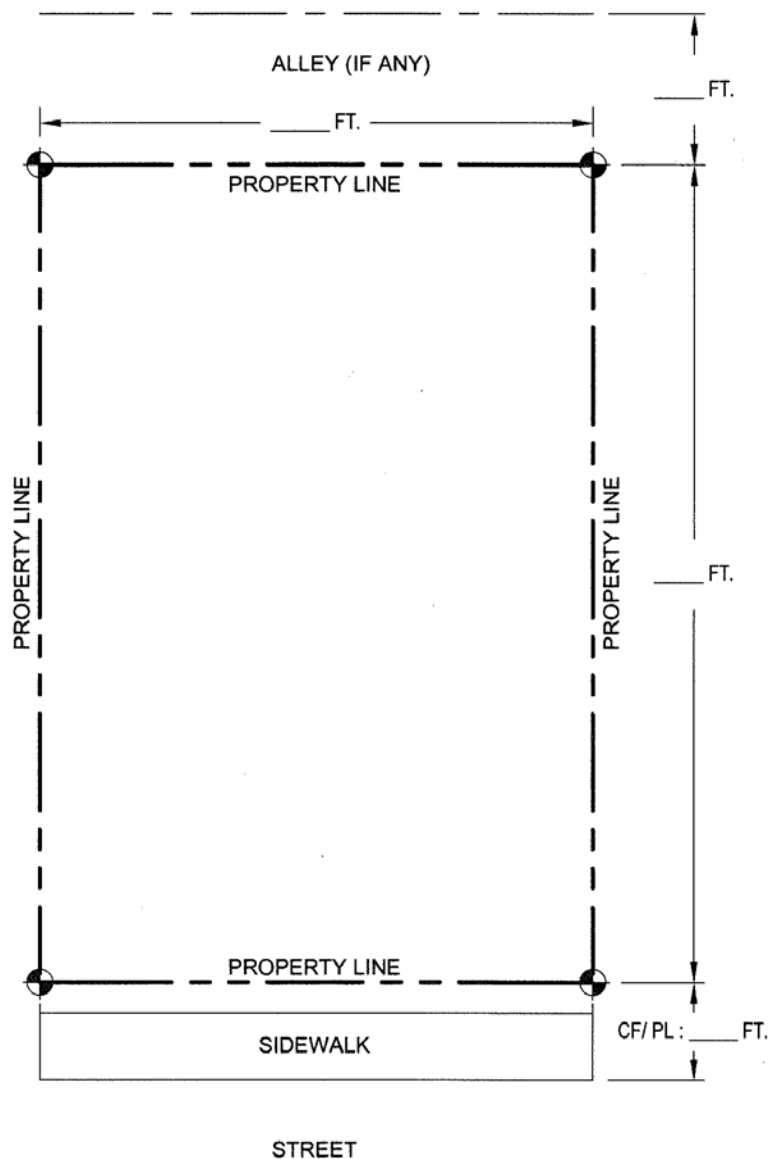

CF/PL = Curb Face to Property Line

FOR OFFICE USE ONLY

ZONE: _____ FENCE HT: _____ SETBACKS: F _____ S _____ R _____

CORNER CUT-OFF REQ'D: _____ SPECIAL SETBACKS: F _____ S _____ R _____

TYPE OF FENCE: Wood _____ Chainlink _____ Block _____ Wrought Iron _____

ZONING APPROVAL: _____ BLDG PERMIT REQ'D: _____



City of Long Beach
411 W. Ocean Blvd., 3rd Floor
Long Beach, CA 90802

Visit us at longbeach.gov/lbcd

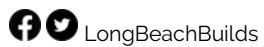

This information is available in alternative format by request at 562.570.3807.
For an electronic version of this document, visit our website at longbeach.gov/lbcd.

Revised: 3/28/25